



Permeable Images

Jesse Ly & Maven Kennedy

ACRE Projects

January 16 through March 1, 2026

Permeable Images, a two-person exhibition with work by Jesse Ly and Maven Kennedy, captures the interconnection between the artists' respective practices, which both situate similar concerns in the relationships between material and representative re-creation. Ly and Kennedy's processes engage shifting perceptions while being tethered to reality - *notating both what falls between as well as their individual relationships with the liminal.*

What is present? – What shows through? – What is held behind? – What is not?

These in-betweens play into the absurdities and ambiguities of collective forms of seeing and the capabilities of peering deeper into these barriers and contradictories. In *Permeable Images*, Ly and Kennedy highlight the commonality within their distinctive approaches, engaging thresholds of world-building through modals of comprehension and connection.

In Kennedy's work, shadows, rusty nails, architectural details, and stones from their time at ACRE are drawn, and screen-printed in natural dyes. They are then transformed into assemblages and installations that allow the viewer to look both at and through them; the imposed image and action of looking through the veil become part of the experience of looking.

Ly contrasts this with photographic rooted works that draw a tension between directness and ambiguity. Grounded in the perceptible and expanded in the emotive, they partner, group and connect their works through visual consistency and framing approaches to create an interplay between each work to expand the tethers to what they allow through. The pictorial indexes - occurred, made, and compiled create variance in what can be seen through and their reflexive properties.

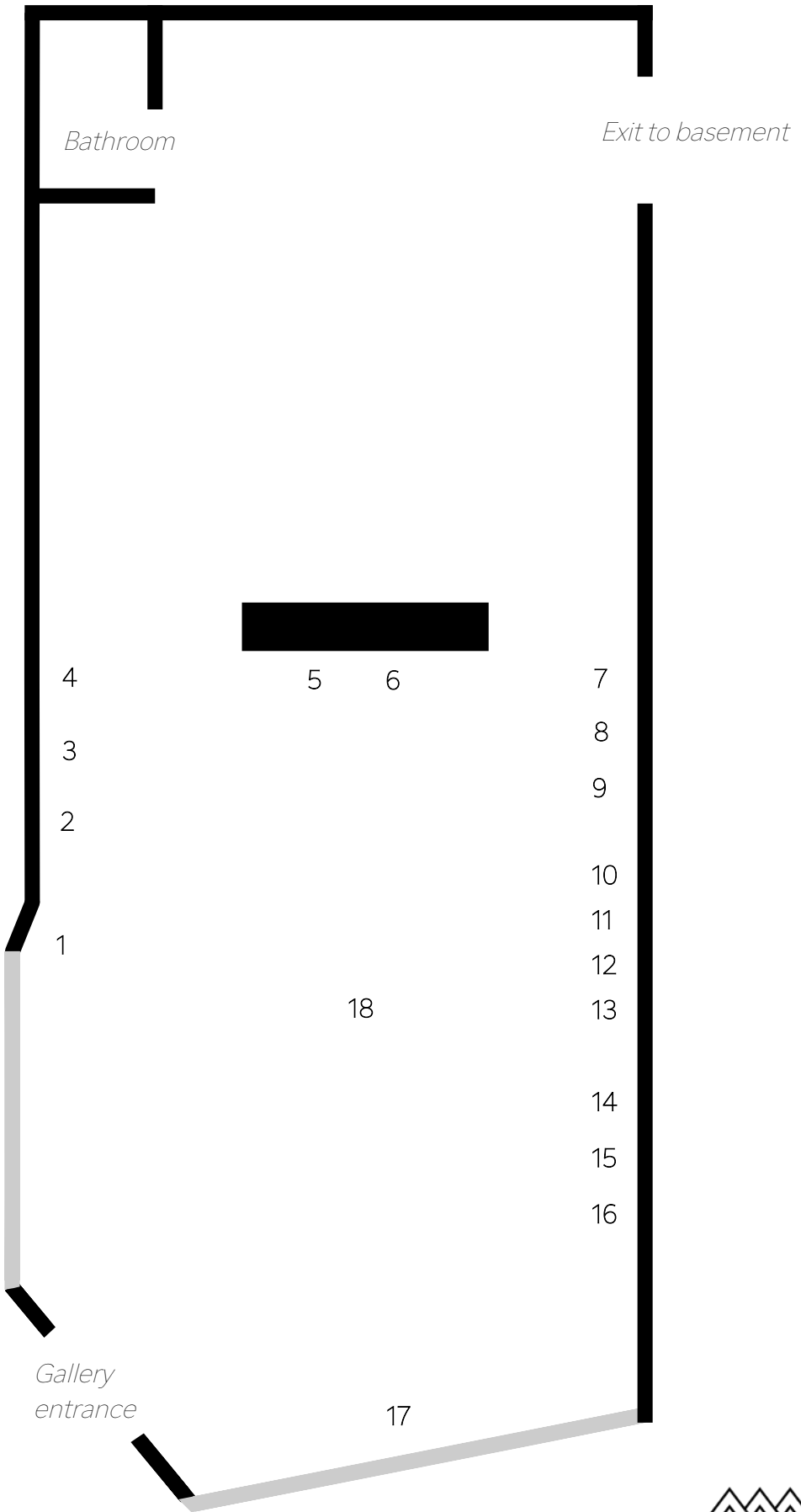

1. Jesse Ly
shelter (organized priority)
16 x 12 x 1.25 inches
Archival inkjet print, handmade walnut frame
2. Maven Kennedy
Contents of a Washed Out Road
36 x 24 inches
Walnut ink, cochineal, onion, skin, citric acid on paper, artist shadowbox frame
3. Jesse Ly
perspectival shifting & showing (i, ii, iii, iv)
14 x 11 x 1.25 inches framed, each Archival inkjet prints, handmade frames with walnut, sapele, cherry & ash
4. Maven Kennedy
The Seams in the Shadows
19 x 11 x 2 inches
Indigo, cochineal, buckhorn and madder dyed cotton, thread, artist shadowbox frame
5. Jesse Ly
fractured radiance
30 x 24 x 1.25 inches
Archival inkjet print, handmade walnut frame
6. Maven Kennedy
Shards or Nothing
30 x 24 x 1.25 inches
Screenprints with ink made from bricks, iron, ashes, goldenrod, peach pits, onion skins, and walnuts in custom walnut frame made by Jesse Ly
7. Jesse Ly
imagine like a really cool snake here (but you just get the water where it was)
16 x 12 x 1.25 inches
Archival inkjet print, handmade walnut frame
8. Maven Kennedy
Waltzing with Ghosts
2025
12 x 12 x 1.5 inches
Indigo dyed and screenprinted paper, artist shadowbox frame
9. Jesse Ly
a glimmer in the garden (what lies behind & beyond)
30 x 24 x 1.25 inches
Archival inkjet prints with embedded mats, handmade sapele frame
10. Jesse Ly
shelter (organized priority)
16 x 12 x 1.25 inches
Archival inkjet print, handmade walnut frame
11. Jesse Ly
i found a rose and thought of you (i)
12 x 9 x 1.25
Archival inkjet print, handmade walnut frame
12. Jesse Ly
a glimmer in the garden (holding)
2024
50 x 24 inches
Archival inkjet prints with embedded mat, eleyet, dried roses and goldenrod, handmade sapele frame
13. Maven Kennedy
Porous Boundaries and Permeable Memories
2025
8.5 x 8.5 x 1.5 inches
Natural dye printed paper, artist shadowbox frame
14. Maven Kennedy
Portal with Lattice
12 x 12 inches
Iron, indigo, lac, madder and buckthorn on linen, thread, artist shadowbox frame
15. Maven Kennedy
Porous Boundaries and Permeable Memories
2025
8.5 x 8.5 x 1.5 inches
Natural dye printed paper, artist shadowbox frame
16. Maven Kennedy
Portal with Lattice
12 x 12 inches
Iron, indigo, lac, madder and buckthorn on linen, thread, artist shadowdbox frame

17. Maven Kennedy
Oculist Witness
Natural dyed and screenprinted
paper on window, inspiration drawn
from photo negative of latticed
window at Lacock Abbey

18. Maven Kennedy
Writing You a Poem with Bricks and Ash
19.25 x 11.25 x 3 inches closed
Bricks, nails, acorns, charcoal in box with
walnut ink printed paper, indigo and
walnut dyed bookcloth

**All works 2026 unless otherwise noted*

About the Artists

Jesse Ly is an Asian-American photographic and image-based artist. They hold a bachelor's degree in Fine Arts with a minor in Art History and a certificate in Critical Visions from the University of Cincinnati's college of DAAP. They currently are the Graphic Design and Photography Media Facilities Coordinator for Art & Design at the University of Dayton.

Ly has exhibited work both nationally across the US and internationally. They have had solo exhibitions at spaces including RoyGBiv Gallery - Columbus, OH; Foster Gallery - Dedham, MA; The Neon Heater - Findlay, OH; and Gallery Photoland - Olympia, WA. They have participated in group exhibitions in spaces including The Contemporary Arts Center - Cincinnati, OH; FotoFilmic - Vancouver, BC; and The PH Museum - Bologna, Italy. among others. They have been a recipient of CultureWorks Artist Opportunity Grants, an Individual Excellence Award from the Ohio Arts Council, a Regional Artist Renewal Grant via the National Endowment for the Arts, and was named a finalist for the Aperture Portfolio Prize in 2023.

Maven Kennedy Maven Kennedy's (they/them) practice is interested in how we archive a physical world in flux. Through hand skills including book and box making, natural dyeing, and hand stitching, Kennedy connects to the knowledge of generations of unknown hands who worked to hold their world together. Their work as a whole is interested in connecting two or more things that could seem separate or worn away from one another. Like dyeing and mending, the alchemy is in the labor and material itself, leading to transformation. They received a Bachelor's Degree from Northeastern Illinois University and MFA from Northern Illinois University where they were awarded the Helen Merritt Fellowship.

Kennedy has had solo exhibitions at Belong Gallery, SXU Art Gallery, Roman Susan, and Parlour and Ramp, as well as site specific installations at Charles Allis Art Museum, STNRD Exhibitions, the Terrain Biennial, and Purple Window Gallery. They have participated in artist residencies at ACRE, Ragdale, Roman Susan, Terrain Exhibitions, Awakenings, Lillstreet Art Center, and the Center Program and Bridge Program at Hyde Park Art Center. They currently serve as the Director at NEIU's Fine Art Center Gallery and teach at Northern Illinois University, their studio is based out of Chicago.